

Yorktown Municipal Riverfront District

DELAWARE COUNTY, INDIANA

NE. COR. NW. QTR.
SEC. 22-20-9



SE. COR. NW. QTR.
SEC. 22-20-9



SCALE
1" = 100'
Total Acreage
±66.96 Ac

SE. COR. NW. QTR.
SEC. 22-20-9

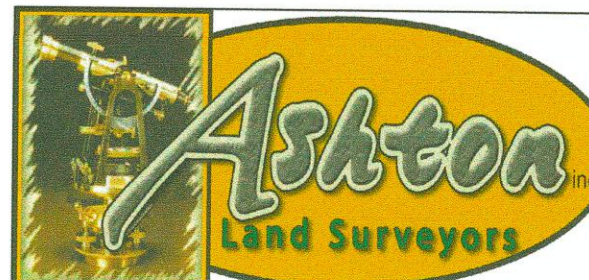

I affirm, under the penalties for perjury, that I have taken reasonable care to redact each Social Security number in this document, unless required by law.
Haldon L. Ashton
This Instrument Prepared by: Haldon L. Ashton

SW. COR. NE. QTR.
SEC. 21-20-9
WOOD POST 3 NORTH

SE. COR. NW. QTR.
SEC. 21-20-9
PK Nail
5/8" IP IN CASTING